

FOR SALE

COMMERCIAL - FACTORY (B2)
3,477SQFT (323SQM) / S\$ 678,000

+65 9068 2309

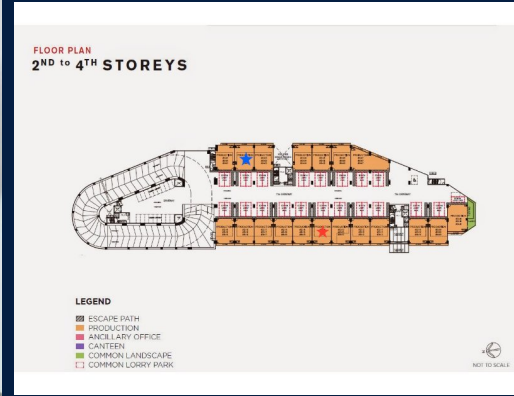

COMMERCIAL - FACTORY (B2)

ACE @ BUROH, 2, BUROH CRESCENT, BOON LAY,
JURONG, TUAS, SINGAPORE 627546

- LISTING ID: SGLA01102363
- TENURE: LEASEHOLD 30
- TITLE: N/A
- SIZE BUILT-UP: 3,477SQFT (323SQM)
- SIZE LAND: N/A
- NO. OF FLOORS: N/A
- FLOOR/LEVEL: N/A - N/A
- PARKING SPACES: N/A
- LAYOUT TYPE: N/A
- FACING: N/A
- VIEWING: N/A
- SELLING PRICE: S\$ 678,000 **NEGOTIABLE**
195PSF (2,098PSM)
- COMPLETION YEAR: 2013
- CONDITION: N/A
- LISTING DATE: OCT 26, 2020

FACTORY (B2) BUROH CRESCENT

This space is perfect to be used as a factory and workshop. The vast amount of space of approximately 3,477 sqft is perfect for warehouse use as well. It is set in the middle of the factory area. It has a 30-year leasehold and its double-storey allows more things to be stored and more space can be used.

VISIT THIS PROPERTY AT: <https://www.pravinproperties.com.sg/property/SGLA01102363>



PRAVIN KUMAR - HUTTONS ASIA PTE LTD

3 Bishan Place #05-01 CPF Bishan Building
D20, 579838, Singapore

+65 9068 2309
WhatsApp Me

pravin@pravinproperties.com.sg

L3008899K
R014139B

<https://www.pravinproperties.com.sg>



Scan QR Code

Huttons® Call for Viewing
The Agency of Choice +65-90682309